



Fife Road, N22

GUIDE PRICE £600,000 - £625,000

**\*\*GUIDE PRICE £600,000 - £625,000\*\***

**FREEHOLD**

A desirable three bedroom 1930's mid-terraced family house, situated on the popular Scotch Estate. The property has been tastefully decorated by the current vendor and benefits new double glazed windows. The ground floor features a through lounge, stylish kitchen with integrated appliances and underfloor heating with access to a picturesque rear garden. The first floor boasts three bedrooms, contemporary bathroom, separate cloakroom and the potential to extend into the loft space and create an additional bedroom or two (subject to planning approval). Fife Road is ideally situated for the vibrant Wood Green shopping area with all its bars and restaurants and with easy access to both Wood Green and Turnpike Lane Underground station. The green open spaces of White Hart Lane Recreation Ground are also close by.



**Fife Road, N22**

Approx. Gross Internal Area 1037 Sq Ft - 96.34 Sq M

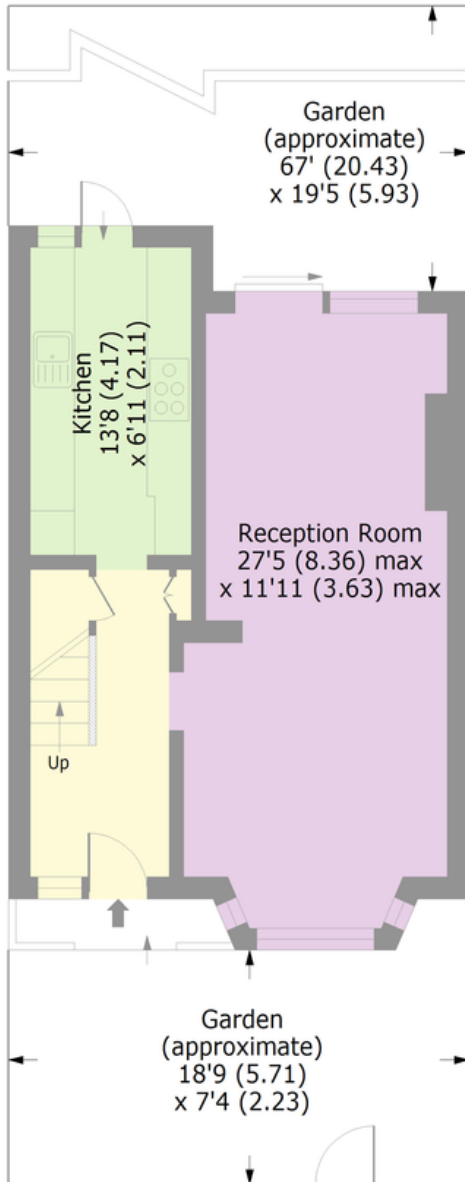

**GROUND FLOOR**

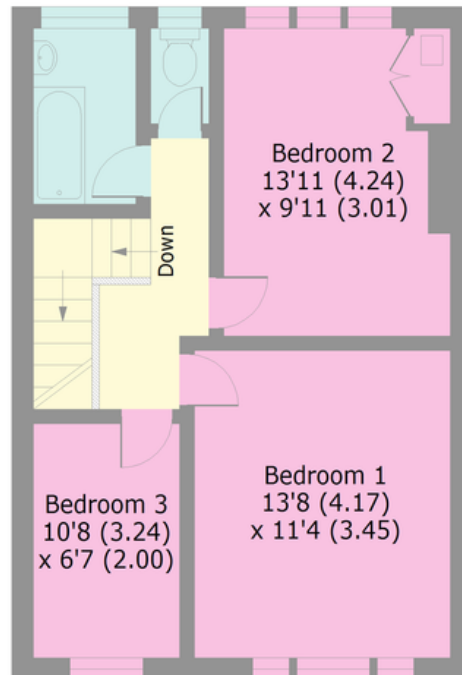

**FIRST FLOOR**



3



Bedrooms

1



Reception

1



Bathroom

Yes



Garden

**Tenure:**  
Freehold

**Energy Efficiency Rating:**  
54

**Bounds Green Office**  
3 Latham Court  
Brownlow Road  
London N11 2ES  
0208-365-8900

**Turnpike Lane Office**  
8 Turnpike Parade  
Green Lanes  
London N15 3EA  
0208-888-0022

[boundsgreen@wilkinsonbyrne.com](mailto:boundsgreen@wilkinsonbyrne.com)

[Turnpikelane@wilkinsonbyrne.com](mailto:Turnpikelane@wilkinsonbyrne.com)